

**1**

Slide the device keyboard under the bottom case's left side clip.

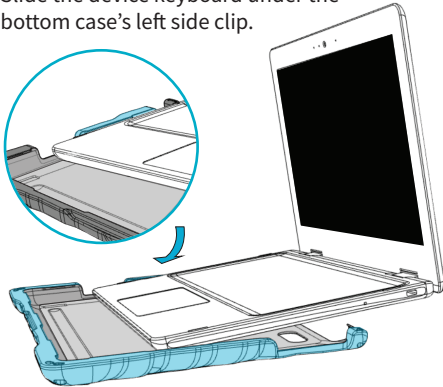

**2**

Press the other side of the keyboard down to snap into the right side clip securely.

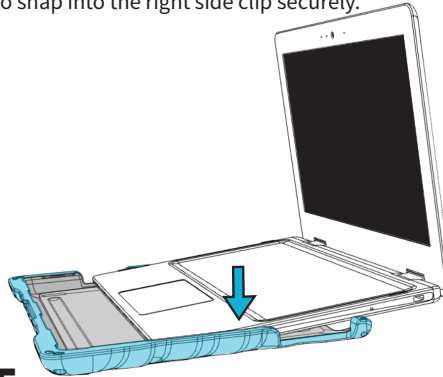

**3**

Push the keyboard forward until it is flush with the front edge of the bottom case.

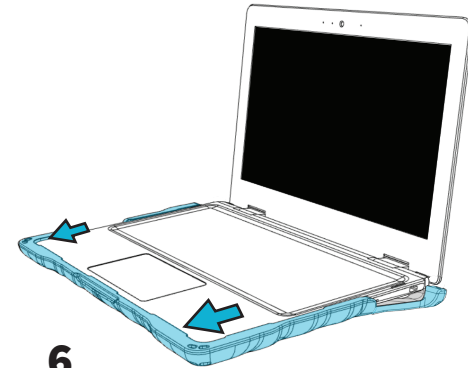

**4**

Carefully press the rear corner clips to snap onto the keyboard.

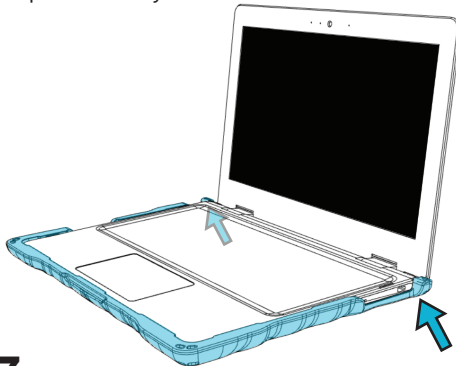

**5**

Slide the top case down, to secure the screen behind the side clips, until the device reaches the case's top edge.

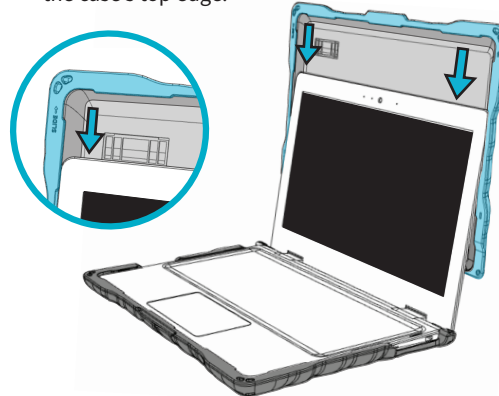

**6**

Press the lower side clips over the device, with pressure from both sides, to snap into place securely.

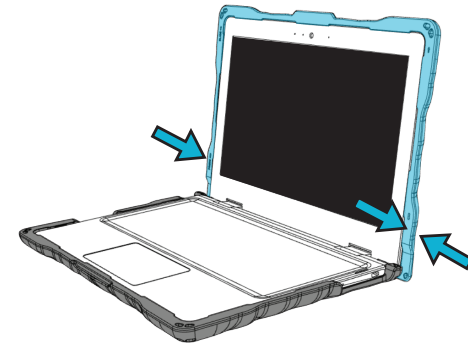

**7**

Close the case and press on the clips located on the bottom of the top case. Make sure the clips are securely attached

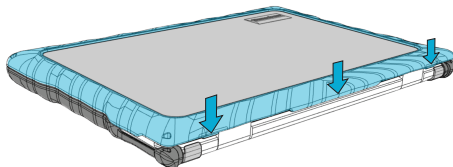

**CRITICAL!**  
**FOLLOW STEPS 1 - 3 IN ORDER**

Failure to do so may result in  
damage to the device.



**1**

Unhook the 3 clips located on the top case's bottom, near the spine.

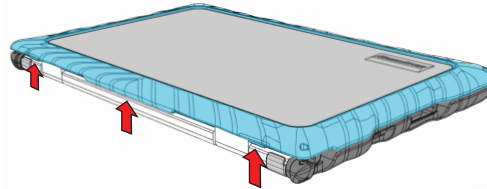

**2**

Push the lower left and right side clips outward to release the bottom of the top case from the device.

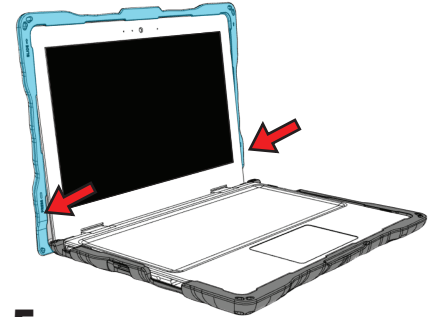

**3**

Start sliding the top case off by pushing up with your fingers on the bottom corners.

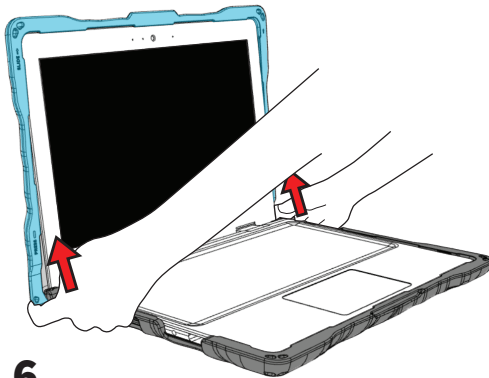

**4**

Gently slide the top case up and off the device to release it from the upper side clips.

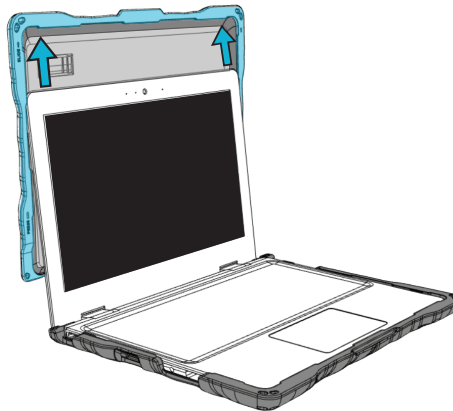

**5**

Gently push the rear clips down to unhook from the device.

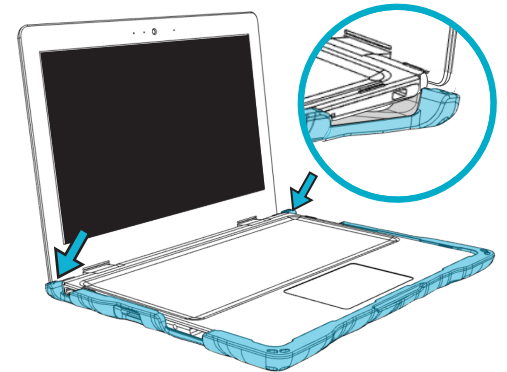

**6**

Push the left and right side clips down past the device, one side at a time, to release it from the bottom case.

